

2687

1698/113



पश्चिम बंगाल WEST BENGAL

15AA 235170

Certified that the document is admitted to registration. The Signature Sheet and endorsement sheet which are attached to this document are the part of this document

A.P.S.R Howrah

26 AUG 2013

DECLARATION FOR BOUNDARY

PREMISES NO.

37/1, Kshetra Mohan Banerjee Lane, Police Station-Shibpur,
District-Howrah, Ward No.33, Borough-IV of H.M.C.

I, **AVIJIT GHOSH**, aged about 48 years, S/o. Late Gopal Chandra Ghosh, by faith-Hindu, by occupation-business residing at 59, Dharmatala Lane, P.S. Shibpur, Dist. Howrah and Director of **M/S. MANGLA GAURI CONSULTANTS PRIVATE LIMITED**, having its Office at 46A/33/3, Shibpur Road, P.S. Shibpur, Dist. Howrah, As Self & Constituted Power of Attorney of Co-owner **SRI ATUL CHANDRA GHOSH**, S/o. Late Abhoy Charan Ghosh, by faith-Hindu, by occupation-business residing at 68, Shibpur Road, P.S. Shibpur, Dist. Howrah, Director of **M/S. SUMERU SUPPLIERS AND TRADERS PRIVATE LIMITED**, having its Office at 68, Shibpur Road, P.S. Shibpur, Dist. Howrah, do hereby solemnly affirm and declare as follows:-

1. That the Plan submitted herewith may kindly be accepted for record is final Boundary Plan of the premises No. 37/1, Kshetra Mohan Banerjee Lane, Police Station-Shibpur, District-Howrah, Ward No.33, Borough-IV of H.M.C.
2. That I along with **SRI ATUL CHANDRA GHOSH**, Director of **M/S. SUMERU SUPPLIERS AND TRADERS PRIVATE LIMITED**, having its Office at 68, Shibpur Road, P.S. Shibpur, Dist. Howrah are absolute owners & occupiers of demarcated Premises No. 37/1, Kshetra Mohan Banerjee Lane, Police Station-Shibpur, District-Howrah, Ward No.33, Borough-IV of H.M.C., the boundary which has been surveyed and duly shown in the annexed site plan.
3. The actual area of land measures 22 Ka. 6 Ch. 00 Sft. more or less.
4. That there is no case pending in both Civil/Criminal Court for the above said premises, if any dispute arise then H.M.C. will be liable to cancel the building sanction plan.
5. We propose to construct a building in the aforesaid premises. The actual boundary Line of the property which is fully mentioned below and demarcated by red colour and we shall be liable for dispute of any with our neighbour of this said land in future. The Howrah Municipal Corporation will not be liable for any litigation over the said land and is at liberty to revoke the plan if any discrepancy arises and action with the law.

6. THE RESPONSIBILITY OF THE GENUINENESS ALL THE FACTS SOLELY LIES ON THE DECLARANT BY THIS DEED. NO POSITIONAL CHANGE HAS BEEN OCCURRED DUE TO THIS DECLARATION.

THE SCHEDULE ABOVE REFERRED TO

All that piece & parcel of land having an area of 22 Ka. 6 Ch. 00 Sft. (more or less) lying and situated within Premises No. 37/1, Kshetra Mohan Banerjee Lane, Police Station-Shibpur, District-Howrah, Ward No.33, Borough-IV of H.M.C., delineated in the map or plan hereto annexed and therein colored in Red bordered and the said land has the following measurements:

- On the North: 13984mm, 12026mm, 8821mm, 6042mm.
 - On the South: 9984mm, 6405mm, 2707mm, 8013mm, 1410, 7924 mm, 346mm,
 - On the East: 3014mm, 3764mm, 6382mm, 1189mm, 18866mm, 1133mm, 7478mm.
 - On the West: 1618mm, 9932mm, 2362mm, 2475mm. 5791mm, 2667mm, 6643mm, 7464mm.
- and butted and bounded by :
- On the North: 10950 Avg. wide Bridge Approach Road.
 - On the South:
 - On the East: 4520mm wide Kshetra Mohan Banerjee Lane
 - On the West:

That the aforesaid declaration will be binding on our heirs, Executors, representatives and assigns.

Signed on this the 26th day of Aug., 2013. *Atul Ghosh*

Witnesses :-
1. *Gannur Kar Khanna*
S/553 Koshinath Chatterjee TRADERS PRIVATE LIMITED.
Same Baner
As Self & Constituted Power of Attorney
of SRI ATUL CHANDRA GHOSH, Director
of M/S. SUMERU SUPPLIERS AND

2. *Amel-Sultta,*
Kadambala,
Handi.
Declarant.

Drafted By me.

Drafter Navrojan Chakraborty

Advocate. *022 7301 73*

Typed by:-
Tapan Chakraborty

BOUNDARY DECLARATION PLAN AT HOLDING NO.- 37/1, KSHETRA MOHAN BANERJEE LANE, P.S.- SHIBPUR,
DIST. - HOWRAH, WARD NO.- 33, BOROUGH - IV,

LAND AREA : 01 BH - 02 KT - 06 CH - 00 SFT (SHOWN IN RED BORDER)

N
(SCALE = 1 : 350)

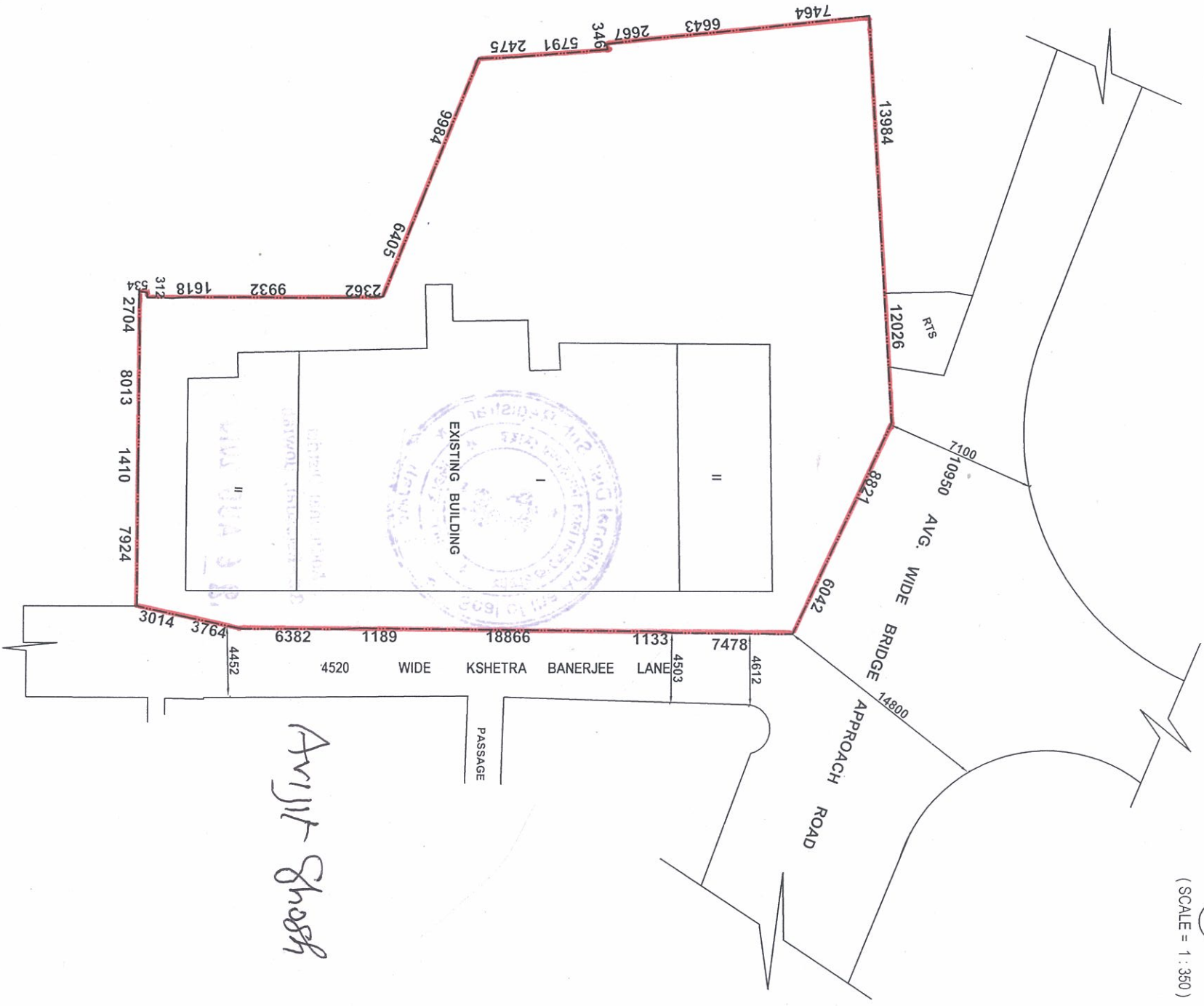

Sl. No. _____
 Picture & Signature of Examinants





Arjit Shroff

Signature of	Left Hand					Right Hand				
	Little	Ring	Middle (Left Hand)	Fore	Thumb	Little	Ring	Middle (Right Hand)	Fore	Thumb
Signature of	Little	Ring	Middle (Right Hand)	Fore	Thumb	Little	Ring	Middle (Left Hand)	Fore	Thumb

Arjit Shroff
 2023-09-04

Government of West Bengal
 Department of Finance (Revenue), Directorate of Registration and Stamp Revenue
 Office of the A.D.S.R. HOWRAH, District- Howrah
 Signature / LTI Sheet of Serial No. 07687 / 2013, Deed No. (Book - I , 06987/2013)

I. Signature of the Presentant

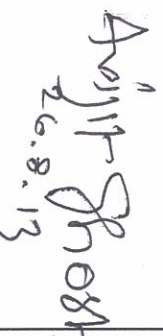
Name of the Presentant	Photo	Finger Print	Signature with date
Avijit Ghosh 59, Dharmatala Lane, Thana:-Shibpur, District:-Howrah, WEST BENGAL, India,		 LTI	
	26/08/2013	26/08/2013	

II. Signature of the person(s) admitting the Execution at Office.

Sl No.	Admission of Execution By	Status	Photo	Finger Print	Signature
--------	---------------------------	--------	-------	--------------	-----------

1	Avijit Ghosh Address -59, Dharmatala Lane, Thana:-Shibpur, District:-Howrah, WEST BENGAL, India,	Self		 LTI	
			26/08/2013	26/08/2013	

Name of Identifier of above Person(s)
 Samir Kr Khanra
 52/53, Kashi Nath Chatterjee lane, Thana:-Shibpur,
 District:-Howrah, WEST BENGAL, India,

Signature of Identifier with Date
Samir kr Khanra
 26.8.13





Government Of West Bengal
Office Of the A.D.S.R. HOWRAH
District:-Howrah

Endorsement For Deed Number : I - 06987 of 2013

(Serial No. 07687 of 2013 and Query No. 0502L000013193 of 2013)

On 26/08/2013

Certificate of Admissibility(Rule 43,W.B. Registration Rules 1962)

Admissible under rule 21 of West Bengal Registration Rule, 1962 duly stamped under schedule 1A,
Article number : 4 of Indian Stamp Act 1899.

Payment of Fees:

Amount By Cash

Rs. 7.00/-, on 26/08/2013

(Under Article : E = 7/- on 26/08/2013)

Certificate of Market Value(WB PUVI rules of 2001)

Certified that the market value of this property which is the subject matter of the deed has been
assessed at Rs.-/-

Certified that the required stamp duty of this document is Rs.- 10 /- and the Stamp duty paid as:
Impresive Rs.- 20/-

Presentation(Under Section 52 & Rule 22A(3) 46(1),W.B. Registration Rules,1962)

Presented for registration at 13.04 hrs on :26/08/2013, at the Office of the A.D.S.R. HOWRAH by
Avijit Ghosh, Executant.

Admission of Execution(Under Section 58,W.B.Registration Rules,1962)

Execution is admitted on 26/08/2013 by

1. Avijit Ghosh

Director, M/s. Mangla Gauri Consultants Private Limited, 46a/33/3, Shibpur Road, Thana:-Shibpur,
District:-Howrah, WEST BENGAL, India,
, By Profession : Business

Identified By Samir Kr Khanra, son of Gour Ch Khanra, 52/53, Kashi Nath Chatterjee lane,
Thana:-Shibpur, District:-Howrah, WEST BENGAL, India, , By Caste: Hindu, By Profession: Others.

(Amal Kumar Naskar)
ADDITIONAL DISTRICT SUB-REGISTRAR

CIOS 30A 33

(Amal Kumar Naskar)
ADDITIONAL DISTRICT SUB-REGISTRAR

Certificate of Registration under section 60 and Rule 69.

Registered in Book - I
CD Volume number 14
Page from 9428 to 9436
being No 06987 for the year 2013.



(Amal Kumar Naskar) 26-August-2013
ADDITIONAL DISTRICT SUB-REGISTRAR
Office of the A.D. S.R. HOWRAH
West Bengal